



Installation Survey Guide - Intu Roller

A

Flush or Recessed Rubber Bead



Measure clear glass width and drop

Min Width: 325mm
Max Width: 1400mm
Max Drop: 2000mm subject to fabric choice
Max Area: 2m²

Proud Rubber Bead



B



Max Bead Depth: 27mm

Min Bead Depth: 11mm

C

Side Extrusion: Standard



Side Extrusion: Large



D

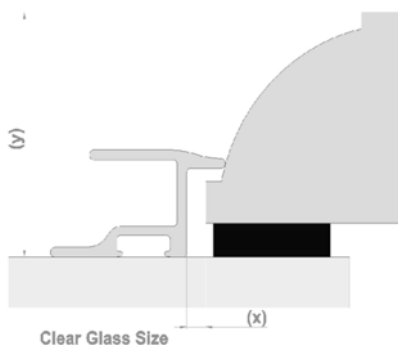

Select side extrusion that gives smallest gap between extrusion and window bead (x)

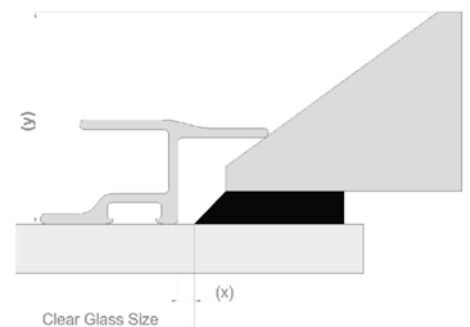



Installation Survey Guide - Intu Roller

E

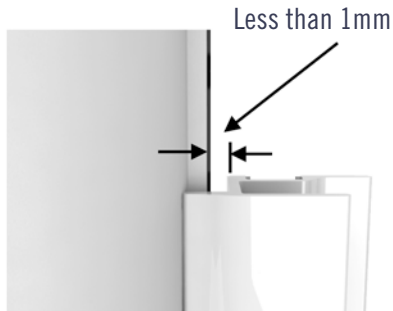

Where the gap is greater than 1mm. This size **MUST BE** deducted from clear glass size (Both sides!)

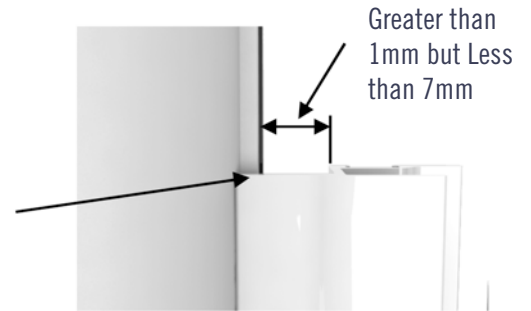

F



Headrail Size

The Headrail size available is 25mm standard only. Ensuring no special instruction necessary.



25mm Standard

G

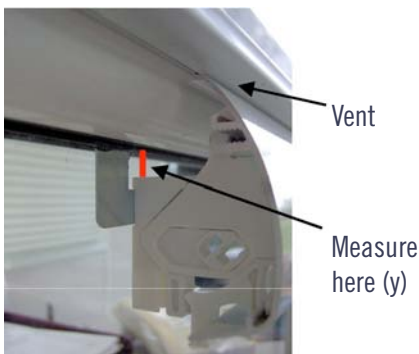

Air Vents Air Vent

When headrail may foul on air vents or other obstructions, a deduction of up to 10mm can be made from the clear glass size(drop).

This can be measured by using a small section of headrail fascia fitted with a fixing bracket.

Enter drop (a) on order form ($x - y = a$)

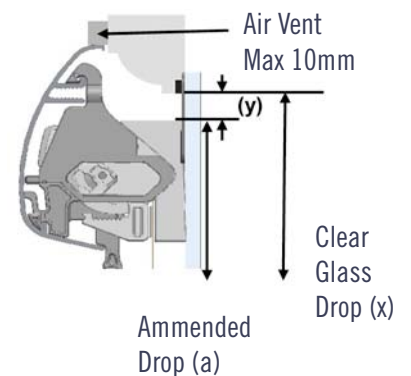



Installation Fitting Guide - Intu Roller

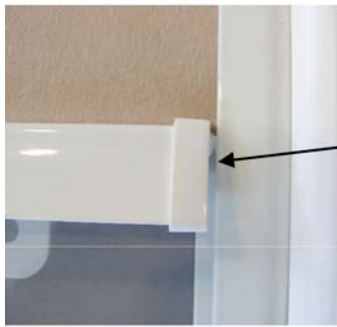

Bottom Bar

When installation is complete, clearance between bottom bar endcap and side extrusion should be checked. This should be parallel along entire length of side extrusion. This can be checked by holding bottom bar tight against one side and measuring the clearance on the opposite side.

Max Clearance: 3mm

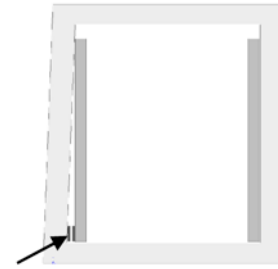

When window is slightly out of square spacer pads should be used to ensure side extrusions run parallel

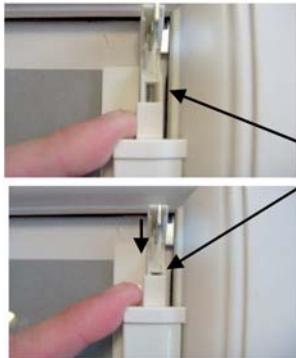

Fabric Alignment

Blind should be checked when installation is complete to ensure that fabric is rolling up parallel. Where this is not the case the blind can be adjusted, as shown left, by moving one side extrusion up or down within the ratchet lock area. This will in turn induce the fabric to roll to one side as required.

e.g. If fabric is rolling off to left hand side, lower right hand corner bracket as shown opposite, this can be done by releasing the side extrusion locking bracket from the ratchet lock, slide corner bracket down, lock side extrusion back in to ratchet lock



Blind Un-Locked

Headrail Lock

After installation ensure that headrail locking arm is fully engaged. This can be checked by looking from below to ensure locking arm is sitting parallel with mating bracket.

It is important to ensure that blind is always left in the locked position.

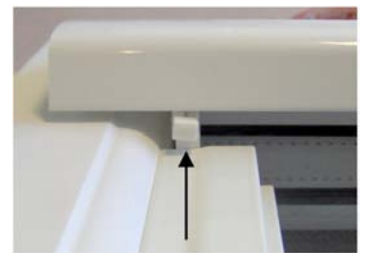

Blind Locked